

INVITATION TO BID
for
2026 Sealcoat Road Projects
Town of Elba, Dodge County

BIDS CLOSE: Tuesday, May 19th, 2026, at 4:30 pm local time

The Town of Elba will receive sealed bids for the 2026 Seal Coat Road Projects at the Elba Town Hall. At the time and date stated above, all bids will be publicly opened and read aloud.

The work for which bids are asked includes the following:

Bid 1 - Chip Seal: Burr Oak Road (From Highway T East to Town of Portland town line, approx 3,696 feet)

Bid 2 – Chip Seal: Soldner Road (4 feet wide, center lane, From County Highway BB East to Town of Lowell town line, approx 4,253 feet)

Bidding documents can be obtained by emailing clerk@townofelba.wi.gov. A hard copy of the documents are on file for viewing at the Elba Town Hall. Please contact the Clerk, Lori Koenig-Fry at 920-728-0269 to set up an appointment.

The Town of Elba reserves the right to reject any and all bids, to waive any technicality and to accept any bid that it deems advantageous. All bids shall remain subject to acceptance for forty-five (45) day after the time set for bid opening. The Contract award shall be made based on the lowest responsive and responsible Bidder.

Published by the authority of the Town of Elba, Lori Koenig-Fry, Town Clerk

Town of Elba 2026 Sealcoat Project

Town of Elba, Dodge County, Bituminous Seal Coat Specifications

1. Seal coat shall be a 3/8" Fractured Stone Aggregate or a Slag Aggregate. The asphalt and aggregate material shall meet WisDOT Roadway Standard Specifications section 475 with the additional aggregate requirement of no more than 1% passing through the #200 sieve.
2. Immediately before applying the asphaltic material, the existing surface shall be cleaned with a power broom or other suitable equipment to remove dirt, clay, or other objectionable matter.
3. Apply tack coat only when the air temperature is 36 degrees Fahrenheit or more and the surface is dry and reasonably free of loose dirt, dust, or other foreign matter. Do not apply if weather or surface conditions are unfavorable or before impending rains.
4. Tack coat shall be applied at a rate sufficient to provide 70% embedment of the aggregate chip into the asphalt after the asphalt has cured and the road is open to traffic.
5. Cover previously applied material as required to create transverse joints without overlapping.
6. Treated areas shall be closed to traffic until after the initial rolling of the cover aggregate has been completed.
7. After the asphaltic material develops sufficient tackiness, aggregate shall be uniformly spread over the treated surface. The aggregate shall be damp to surface dry when applied.
8. Aggregate shall be applied at a rate to completely cover the treated surface but limited to an amount easily embedded in and bonded by the asphaltic material.
9. The surface shall be rolled immediately after spreading the aggregate, beginning at the edges and continuing to the center, lapping 1/2 the roller width on each successive pass. After the initial rolling, perform subsequent rolling until the aggregate is thoroughly embedded and the surface is smooth and uniform in texture. Roller speed shall not exceed 5 mph and care should be taken when reversing roller direction to avoid displacing or loosening the cover aggregate, or damaging the asphaltic material. All rolling shall be completed with by pneumatic rollers of good operating condition.
10. Final sweeping or vacuuming of the excess material in the treated area shall be done by the contractor.
11. Traffic on the newly placed seal coat shall be limited to 25 mph for 24 hrs after the application. Temporary speed limit signs shall be posted and supplied by the contractor and shall be in accordance with the Wisconsin MUTCD. All signing and flagmen to be provided by the bidder per Wisconsin MUTCD standards.
12. Alternate bids are not mandatory and are optional.
13. All Work shall be completed prior to September 3rd, 2026.
14. All work to be done shall be coordinated with the Town of Elba, giving at least one week notice prior to starting.
15. Bidder shall include with the bid, type of material and an estimate of total material quantities to be used.
16. Bidder shall include with the bid, a copy of proof of insurance.

BIDDING PROCEDURE:

All bidders must complete this proposal form and submit it in a sealed envelope identified as **“Town of Elba 2026 Sealcoat Project”**. Proof of insurance shall be included with the bid. Sealed bids are due by **4:30 pm Tuesday May 19th, 2026** at the Elba Town Hall located at N3799 Co Rd T, Columbus, WI and will be opened at that time. No bid may be withdrawn for a period of 30 days after the scheduled bid opening.

Bid 1 and Bid 2 may be in the same envelope.

It is the Town’s intent to award all projects to one bidder.

Contractor is responsible for verifying roads lengths and widths to give a Lump Sum Bid. Mileage in bid documents was obtained by County GIS and not measured in the field.

The Town of Elba reserves the right to reject any or all bids; to waive any conditions of bidding; or to accept any bid that may be most advantageous to the Town of Elba.

Date _____

Company Name _____

Contact Person _____

Address _____

Phone _____

Email _____

Bid Form – Bid 1

No.	Item	Lump Sum Amount
1	Provide all labor, materials, and equipment necessary to seal coat approximately 3,696 feet of Burr Oak Road	\$

Total Bid Price \$

Bid Form – Bid 2

No.	Item	Lump Sum Amount
1	Provide all labor, materials, and equipment necessary to seal coat approximately 4,253 feet of Soldner Road	\$

Total Bid Price \$

STATE OF WISCONSIN
 WISCONSIN DEPARTMENT OF TRANSPORTATION
 TOWN PLAT RECORD

14-014

DATE	MILEAGE FOR LOCAL ROADS/STREETS	LOCAL ROADS/STREETS
(1) 4-1-23	45.94	Certified in accordance with sec. 89.30 Wis. stat.
(2) 1-1-24		Name: _____ Title: _____
(3) 4-1-24		Signature: _____ Date: _____

MILEAGE FOR COUNTY TRUNKS	MILEAGE FOR LOCAL ROADS/STREETS
21.61	00.00

TOWN OF
ELBA
 COUNTY: DODGE

- (1) THIS DATA REPRESENTS THE LAST CERTIFIED MILEAGE AS CORRECTED BY WISDOT WHICH MAY HAVE BEEN USED FOR PAST TRANSPORTATION AIDS.
- (2) THE TOWN CHAIRMAN OR CITY/VILLAGE CLERK IS TO FILL IN THE MILEAGE TO BE CERTIFIED AS OPEN TO THE PUBLIC AS OF THE FOLLOWING JANUARY, INCLUDING THE NEW CHANGES THAT ARE MADE ON THE PLAT.
- (3) THIS DATA REPRESENTS MILEAGE ADJUSTMENTS MADE BY WISDOT DUE TO FIELD VERIFICATION, INVENTORY, ANNEKTATION, ETC. TRANSPORTATION AID PAYMENTS MAY BE MADE BASED ON THIS FIGURE.

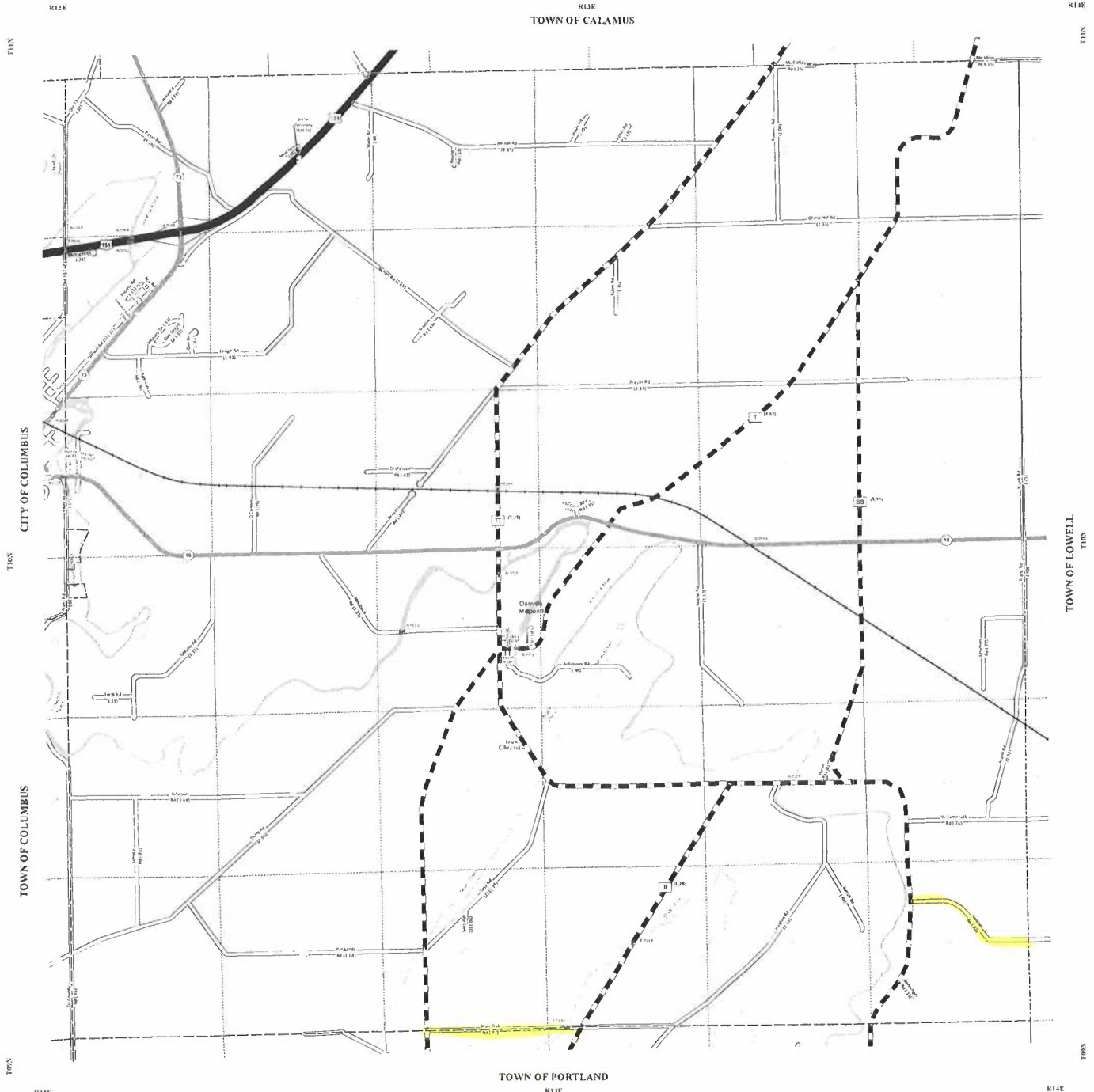

LEGEND

County Trunk Highway	CVT Border
Local Road	PLSS Border
US Highway	Bridge
State Trunk	Route Identifier
State On/Off Ramp	
State Connecting Highway	
Railroad	

The information contained on this map was prepared for the official use of the Wisconsin Department of Transportation (WisDOT). It is not intended for use by any other agency or individual. The user assumes all liability regarding the use of this information for other than official WisDOT purposes.